

Designer: MONMAYA

A medium-sized and slightly modified version of the traditional Japanese "Sendai Tansu" or a warrior's chest of drawers, the Wooden Lacquer Cabinet flaunts a complicated and time-consuming lacquer technique called kijiro-urushi. The method involves using high-grade lacquer through 30 different processes.

Despite the mirror-like surface, the beautiful wooden grain of the zelkova tree can be seen through the transparent lacquer coat underneath, making this a unique and beautiful addition to your home. The drawers are made of paulownia wood known for efficiently controlling moisture. The chest can be used as a decorative piece or to store luxury watches, silk scarves, and other precious items.

This Wooden Lacquer Cabinet won the 2011 Good Design Award.

Dimensions: L56 x W35 x H73 cm

Note: This product is made to order. Before adding to cart, please contact cs@vermillionlifestyle.com for detailed enquiries.

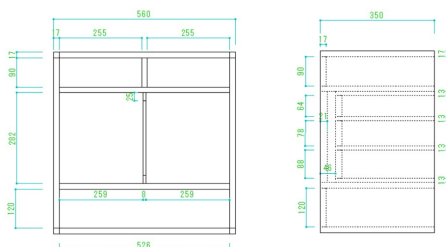

Primary Material: Wood

Primary Color: Brown

Customization: This product is not

customizable.

